

Parts

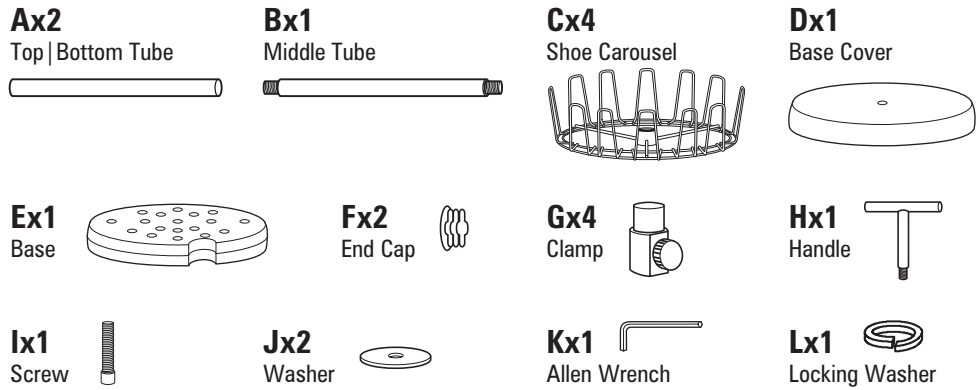

Assembly

- Slide Washer (J) and Locking Washer (L) onto Screw (I). Slide Base (E) onto Screw (I). Add second Washer (J). Place Base Cover (D) onto Screw (I).
- Slide Bottom Tube (A) onto Screw (I). Hold Bottom Tube firmly and using Allen Wrench (K), tighten screw until snug.
- Loosen screw on Clamp (G) and slide onto Bottom Tube (A). Slide Shoe Carousel (C) onto Bottom Tube (A).
- Repeat Step 3.

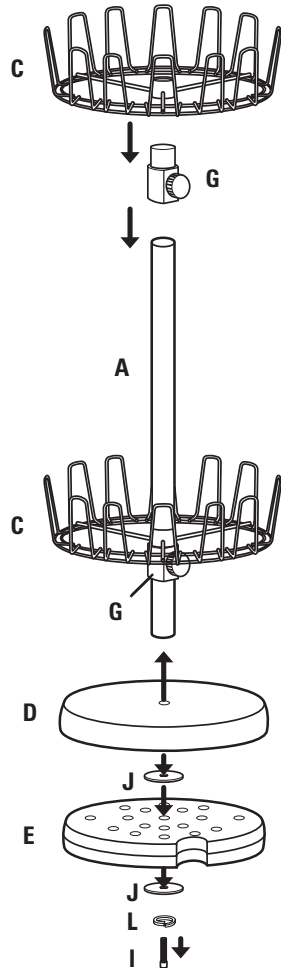

***NOTE:** Washers (J) must be assembled one on top and one on the bottom of Base (E) or the unit will wobble.

Assembly con't

- Push End Caps (F) firmly into holes on Handle (H).
- Screw Handle (H) into Bottom Tube (A). Tighten until secure.
- Slide Shoe Carousel (C) onto bottom of Tube (A). Slide Clamp (G) up to Shoe Carousel (C) and tighten screw.

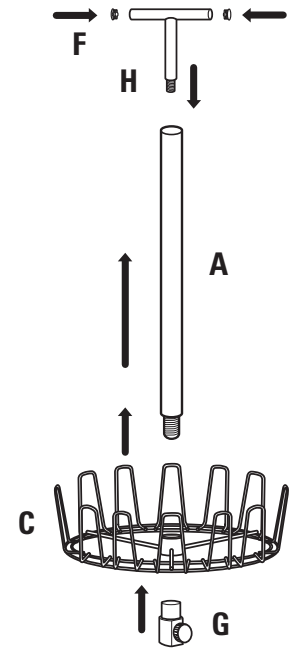

- Screw Top Tube (B) into Bottom Tube (A). Tighten until secure.
- Slide each Shoe Carousel (C) to desired height and secure by sliding Clamp (G) up to Shoe Carousel (C) and tightening screw.

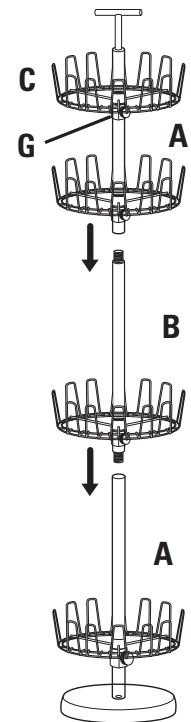

***NOTE:** Part "G" - Do not overtighten screw on sliding clamp. This may cause part to break.